

# Salisbury Road

## ST ANNE'S

APPROXIMATE FLOOR AREA  
70.7 SQM / 761 SQFT



GROUND FLOOR  
393 sq.ft. (36.5 sq.m.) approx.

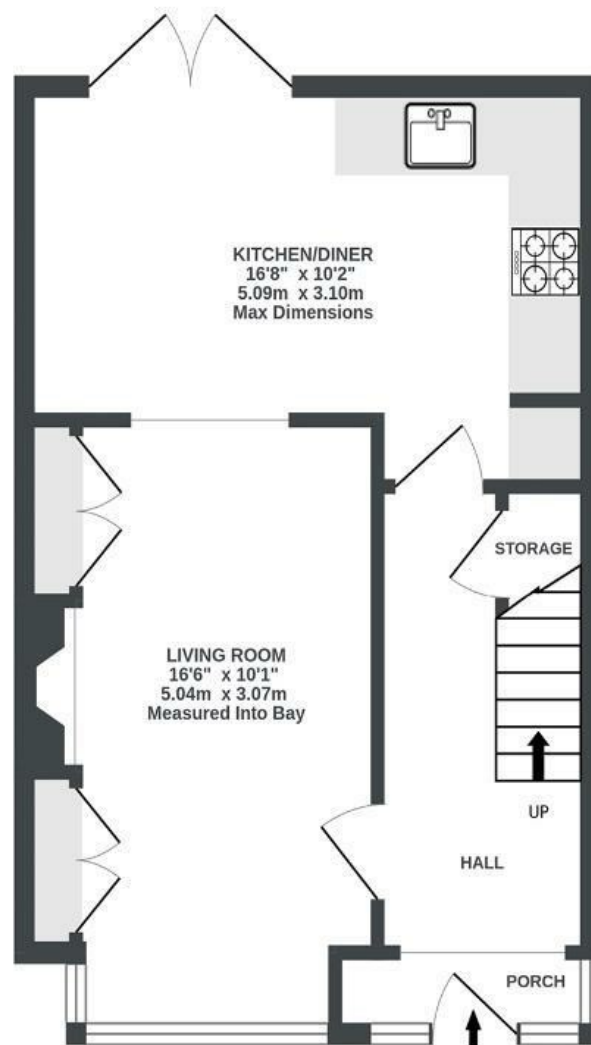

1ST FLOOR  
368 sq.ft. (34.2 sq.m.) approx.

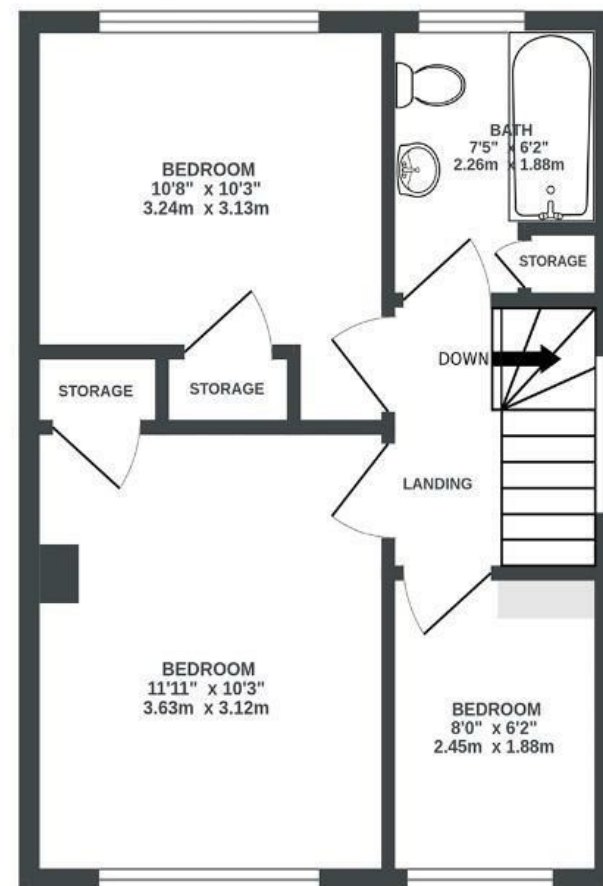

Illustrations are for reference purposes only, measurements are approximate, not to scale.

Boardwalk

# Salisbury Road

ST. ANNES PARK, BRISTOL



£385,000



3 Bedrooms



BS4 4EL



1 Bathrooms

*"We have loved living on Salisbury Road. The garden has been a tranquil place to enjoy the sunshine all day, and into the evening. We love sitting under the pergola and enjoying a morning coffee, or a Gin and Tonic in the evening surrounded by flowers, often watching hot air balloons float overhead. In the colder months the kitchen dining area becomes a place to be together, whilst one of us cooks and we discuss the events of the day. We love our kitchen, its perfect for a couple of foodies!"*

